

Soils Map

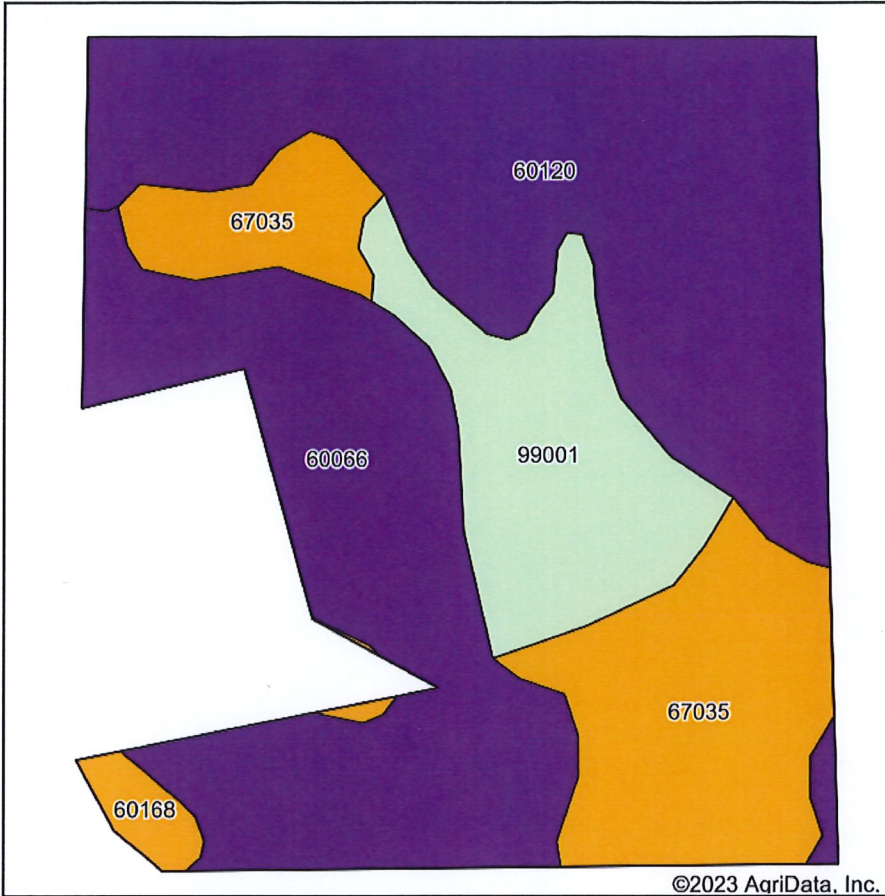

Soils data provided by USDA and NRCS.

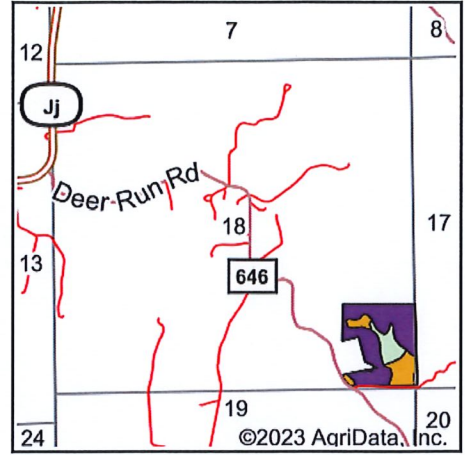

State: **Missouri**
 County: **Lincoln**
 Location: **18-50N-2E**
 Township: **Burr Oak**
 Acres: **33.23**
 Date: **8/25/2023**



Area Symbol: MO113, Soil Area Version: 25

Code	Soil Description	Acres	Percent of field	Non-Irr Class Legend	Non-Irr Class *c	Alfalfa hay Tons	Caucasian bluestem Tons	Common bermudagrass Tons	Orchardgrass red clover Tons	Tall fescue Tons	Warm season grasses Tons	*n NCCPI Overall	*n NCCPI Corn	*n NCCPI Small Grains	*n N Soy
60120	Goss-Gasconade-Brussels complex, 9 to 70 percent slopes, very stony	12.22	36.8%		Vlle							10	10	8	
60066	Brevator loam, 14 to 30 percent slopes	9.51	28.6%		Vle	5	7	6	7	6	7	40	40	32	
67035	Haymond silt loam, 1 to 3 percent slopes, frequently flooded	6.46	19.4%		Illw							68	68	56	
99001	Water	4.47	13.5%												
60168	Menfro silt loam, 5 to 9 percent slopes, eroded	0.57	1.7%		Ille							79	79	66	
Weighted Average					*-	1.4	2	1.7	2	1.7	2	*n 29.7	*n 29.7	*n 24.1	

*n: The aggregation method is "Weighted Average using all components"

*c: Using Capabilities Class Dominant Condition Aggregation Method

*- Non Irr Class weighted average cannot be calculated on the current soils data due to missing data.

Soils data provided by USDA and NRCS.