

# Soils Map

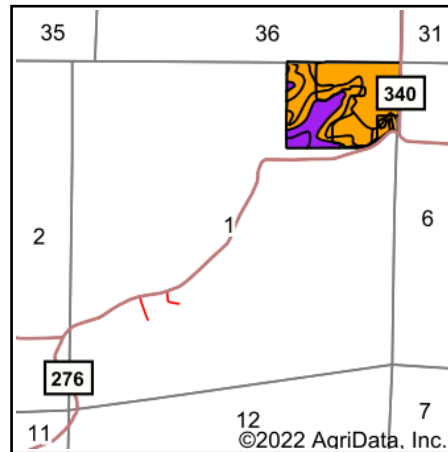

State: **Missouri**  
 County: **Montgomery**  
 Location: **1-47N-6W**  
 Township: **Danville**  
 Acres: **66.01**  
 Date: **5/21/2022**

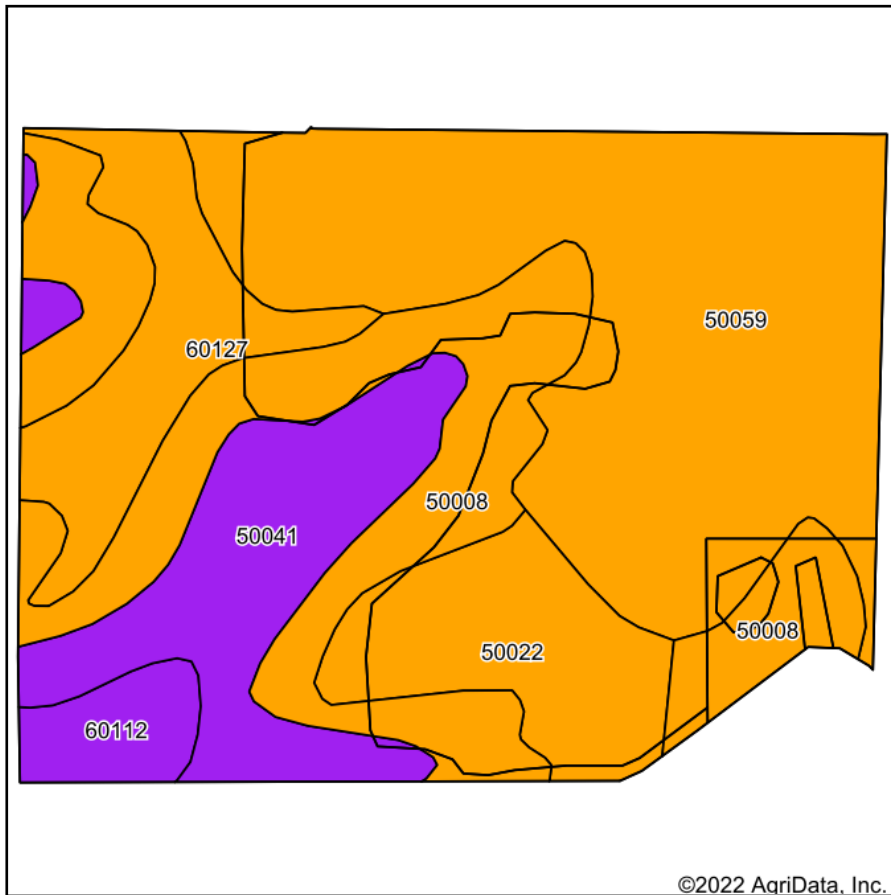

Soils data provided by USDA and NRCS.

Area Symbol: MO139, Soil Area Version: 21

| Code                    | Soil Description  | Acres | Percent of field | Non-Irr Class Legend | Non-Irr Class *c | Alfalfa hay Tons | Caucasian bluestem Tons | Common bermudagrass Tons | Orchardgrass red clover Tons | Tall fescue Tons | Warm season grasses Tons | *n NCCPI Overall | *n NCCPI Corn  | *n NCCPI Small Grains | *n NCCPI Soybean |             |
|-------------------------|---|-------|------------------|----------------------|------------------|------------------|-------------------------|--------------------------|------------------------------|------------------|--------------------------|------------------|----------------|-----------------------|------------------|-------------|
| 50059                   | Mexico silt loam, 1 to 4 percent slopes, eroded         | 25.37 | 38.4%            |                      | IIIe             |                  |                         |                          |                              |                  |                          | 72               | 72             | 62                    |                  |             |
| 50008                   | Keswick silt loam, 5 to 9 percent slopes, eroded        | 16.37 | 24.8%            |                      | IIIe             |                  |                         |                          |                              |                  |                          | 61               | 61             | 56                    |                  |             |
| 50041                   | Lindley loam, 14 to 40 percent slopes                   | 9.44  | 14.3%            |                      | VIe              |                  |                         |                          |                              |                  |                          | 23               | 23             | 19                    |                  |             |
| 50022                   | Calwoods silty clay loam, 2 to 5 percent slopes, eroded | 6.50  | 9.8%             |                      | IIIe             | 5                | 8                       | 7                        | 7                            | 8                | 7                        | 58               | 56             | 58                    |                  |             |
| 60127                   | Hatton silt loam, 3 to 9 percent slopes                 | 6.19  | 9.4%             |                      | IIIe             | 3                | 6                       | 4                        | 5                            | 5                | 6                        | 60               | 57             | 60                    |                  |             |
| 60112                   | Goss very gravelly silt loam, 14 to 45 percent slopes   | 2.14  | 3.2%             |                      | VIIe             |                  |                         |                          |                              |                  |                          | 16               | 16             | 12                    |                  |             |
| <b>Weighted Average</b> |   |       |                  |                      |                  | <b>3.56</b>      | <b>0.8</b>              | <b>1.4</b>               | <b>1.1</b>                   | <b>1.3</b>       | <b>1.2</b>               | <b>1.4</b>       | <b>*n 57.9</b> | <b>*n 57.5</b>        | <b>*n 52.2</b>   | <b>*n 4</b> |

\*n: The aggregation method is "Weighted Average using all components"

\*c: Using Capabilities Class Dominant Condition Aggregation Method

Soils data provided by USDA and NRCS.